

# UNIVERSITY OF MIAMI SCHOOL OF ARCHITECTURE

Spring 2012 • Campus Map • Ground Floor

## FACILITIES

Academic Services .....	48 110
<b>Student Lounge .....</b>	<b>49 130</b>
CUCD .....	49 122
Glasgow Lecture Hall .....	JMPAC 108
Irvin Korach Gallery .....	JMPAC 120
Knight Program .....	35 110
<b>Materials Lab .....</b>	<b>35 130</b>
Model Shop .....	35 150
Old Gallery .....	48E 120
Paul Buisson Library .....	48 130
Rinker Classroom .....	JMPAC 130

## OFFICES

Abella, Luis .....	48 110A
Alexander, Jude .....	48 110D
Bohl, Chuck .....	35 110A
Bixby, Natalie .....	35 110
Correa, Jaime .....	35 130A
De La Paz, Ivonne .....	48 110C
Greenan, Gary .....	35 120A
Guerreo, Carmen .....	49 120
Pizarro, Julia .....	48 110
Santana, Ana .....	48 110B
Santana, Gilda .....	48 130E
Villaraos, Adrian .....	35 150

## STUDIO SPACES

<b>ARC102: Martinez .....</b>	<b>49 131</b>
<b>ARC306: Onyango .....</b>	<b>49 111</b>
<b>ARC306: Trelles .....</b>	<b>49 110</b>
<b>ARC502: Brillhart .....</b>	<b>49 140/141</b>
Furniture Design Course .....	35 140
V: Caraballo/Greenan .....	35 120

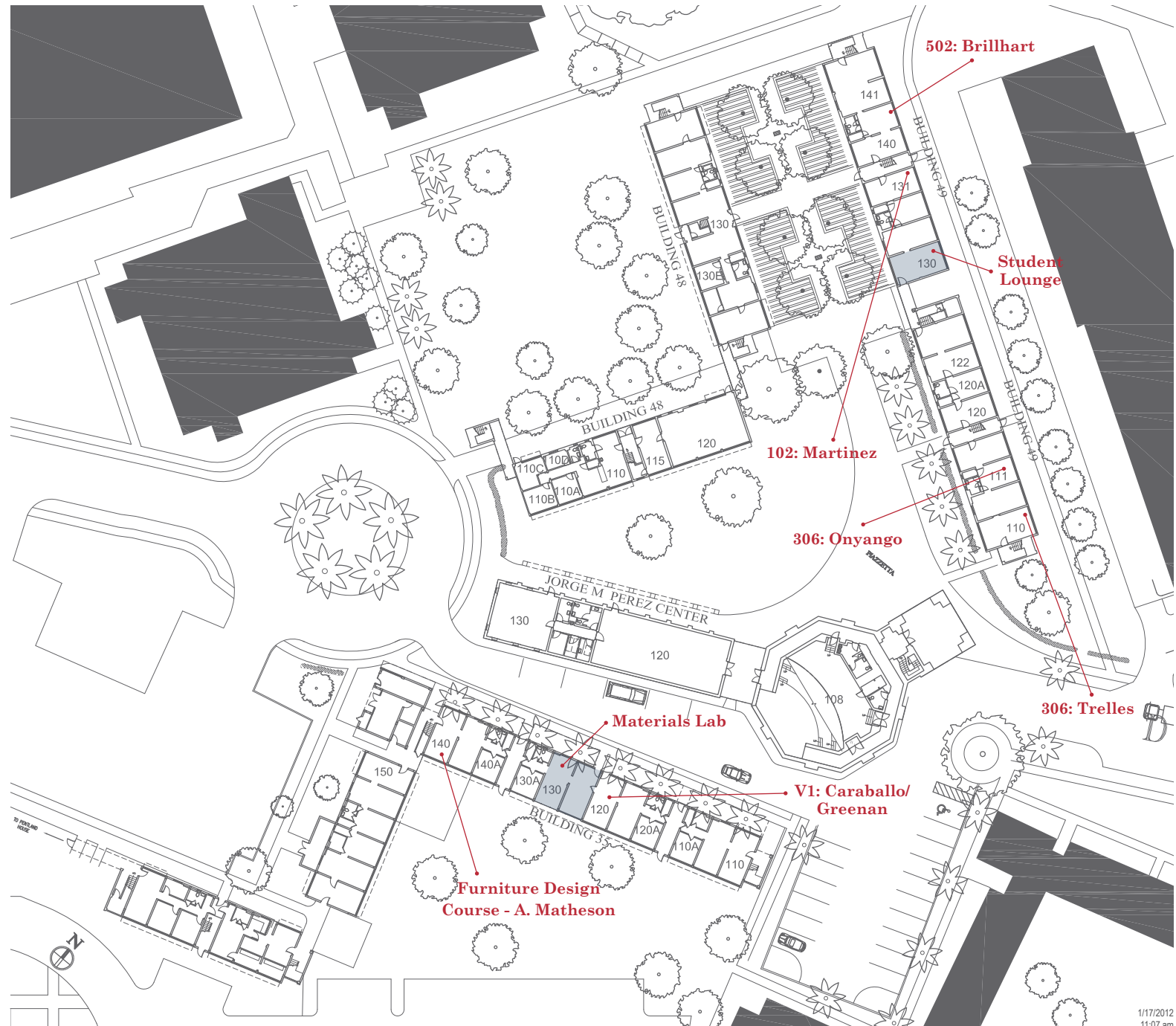

# UNIVERSITY OF MIAMI SCHOOL OF ARCHITECTURE

Spring 2012 • Campus Map • Second Floor

## FACILITIES

Budget Office .....	48 220F
Computer Lab .....	48 230
Faculty Services .....	48 220
Office of the Assistant Dean .....	48 210A
Office of the Assistant to Dean .....	48 210B
Office of the Dean .....	48 210C
Public Relations .....	48 220E
Slide Library .....	48 230D

## OFFICES

Carbonell, Barbara .....	48 220F
Cornielle, Ruddy .....	48 230B
Fix, David .....	35 220A
Fornes, Rafael .....	35 240
Garcia, Isa .....	48 220F
Grana, Iliana .....	48 210B
Hector, Denis .....	48 210A
Hernandez, Jorge .....	35 230A
Jaggernaut, Gary .....	48 230J
Lopez, Zoila .....	48 220
Paulino, Manuel .....	48 230C
Plater-Zyberk, Elizabeth .....	48 210C
Wheeler, Katherine .....	35 210A
White, Carolyn .....	48 220E

## STUDIO SPACES

ARC102:Machado.....	49 230
ARC102:Lopez-Gottardi.....	49 230
ARC204: Penabad .....	49 221
ARC306: Trautman .....	49 220
ARC306: Gelabert-Navia.....	49 211
ARC306: Krantz .....	49 210
ARC610: Thesis.....	35 250/251
Hines 2 : .....	35 252
Seminar Rm. (ARC292: Alvarez).....	35 270
V: John .....	35 220
V: Lombard .....	35 210
V: J. Perez .....	35 260
V: Sarli .....	35 230
VC: Ceo/Adamson.....	35 240

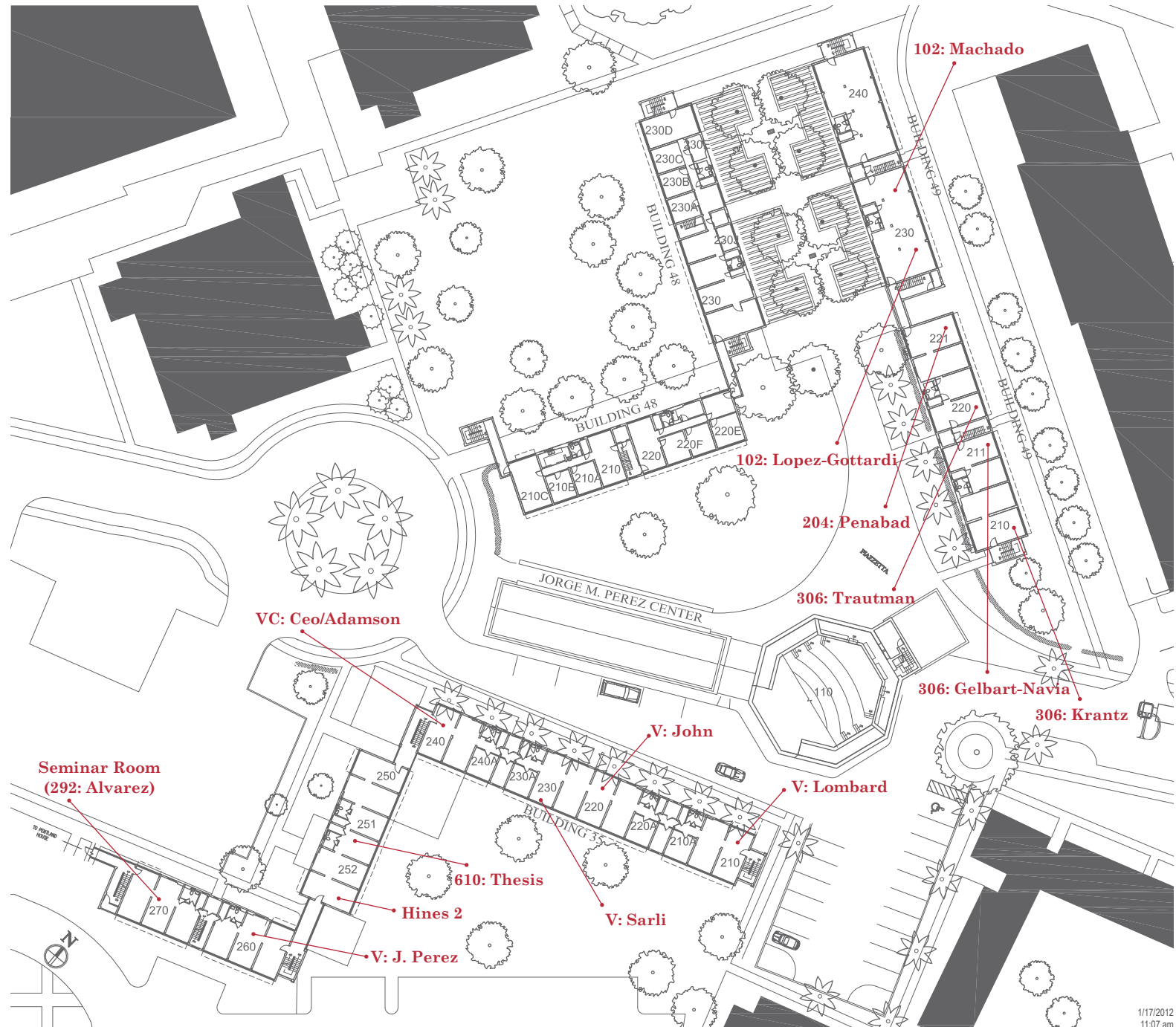

V: Vertical Studio  
VC: Visiting Critic

# UNIVERSITY OF MIAMI SCHOOL OF ARCHITECTURE

Spring 2012 • Campus Map • Third Floor

## FACILITIES

Media Room .....	48 330
Third Floor Jury Room .....	49 310

## OFFICES

Behar, Roberto .....	35 310A
Brillhart, Jacob .....	48 330G
Ceo, Rocco .....	48 320A
Chao, Sonia .....	48 330B
Cure, Adib .....	35 330A
Firley, Eric .....	48 312D
Gelabert-Navia, Jose .....	35 320A
Lejeune, Jean-Francois .....	48 310C
Lombard, Joanna .....	48 310
Lopez-Gottardi, Tomas .....	48 310B
Martinez, Frank .....	48 320B
Middlebrooks, Joseph .....	48 330E
Millas, Aristides .....	48 330D
Onyango, John .....	48 310
Patricios, Nicholas .....	48 330C
Penabad, Carie .....	35 340A
Roche, Sam .....	48 320C
Shulman, Allan .....	48 330H
Spain, Thomas A. ....	48 330F
Victoria, Teofilo .....	48 330C

## STUDIO SPACES

Alumni Studio .....	35 360
ARC102: Behar .....	49 330
ARC102: Caraballo.....	49 330
ARC204: Valbrun .....	49 321
ARC204: Chao .....	49 320
ARC204: Roche .....	49 311
ARC204: Firley .....	49 310
Hines 1/V: MREDU .....	35 370
V: Cure .....	35 330
V:Montero .....	35 310
V: Victoria .....	35 320
VC: Clave/Phillips .....	35 340

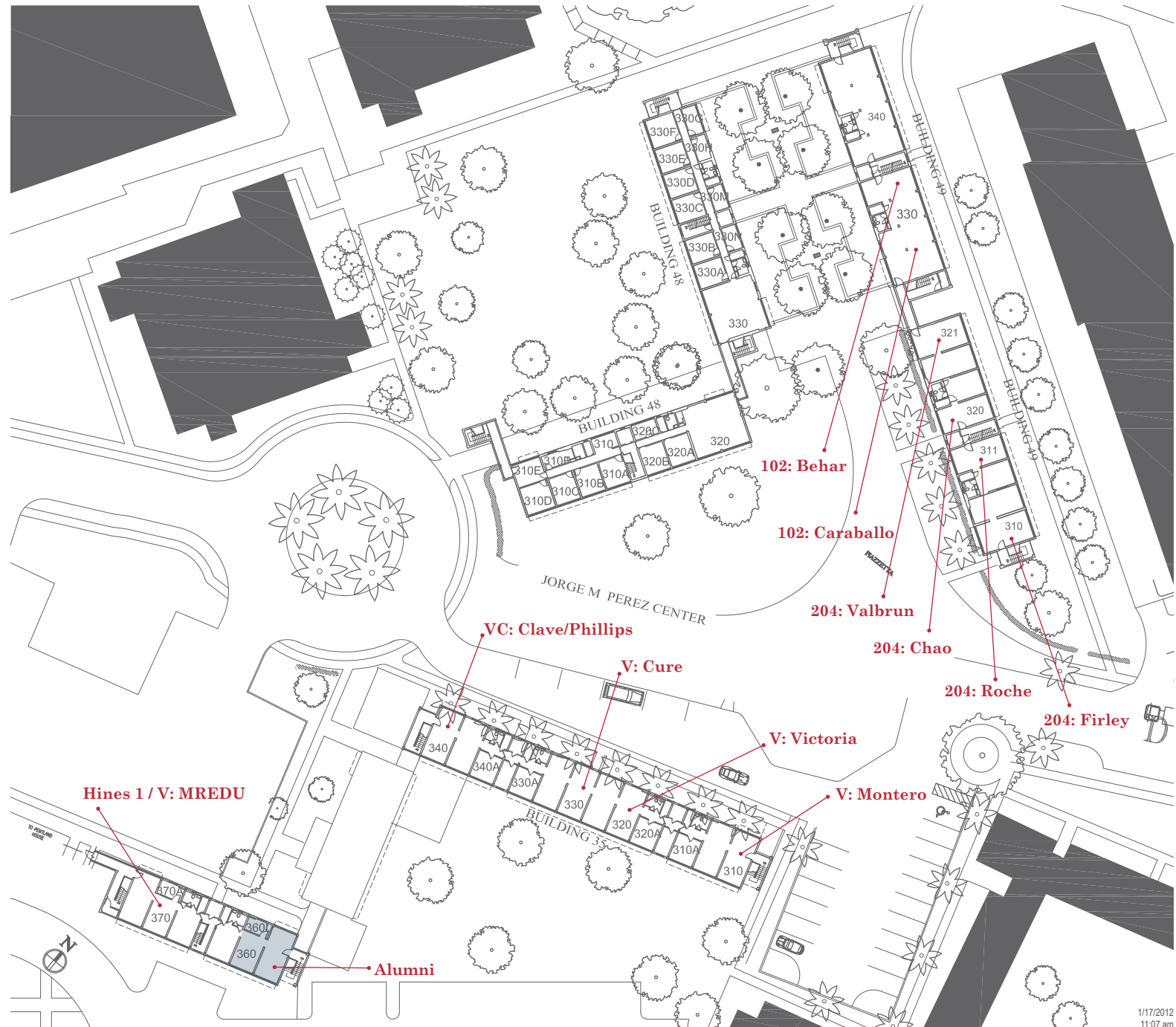

V: Vertical Studio  
VC: Visiting Critic